

S4000 / SÜRME - SLIDING

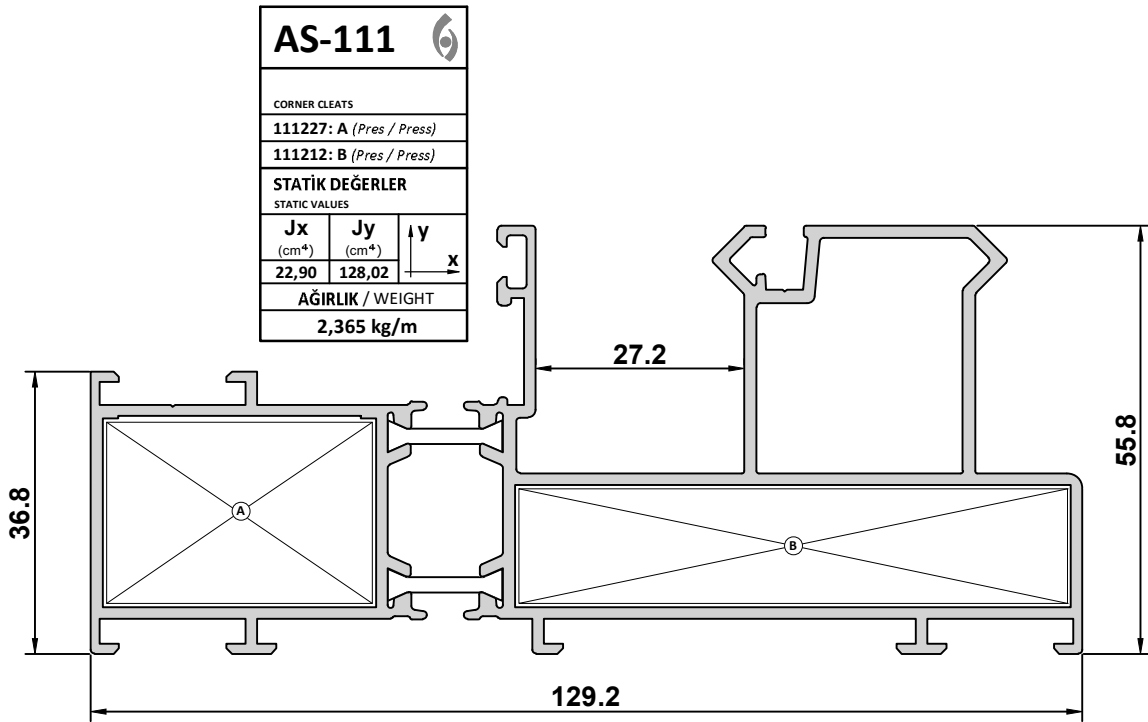

S4000 / SÜRME - SLIDING

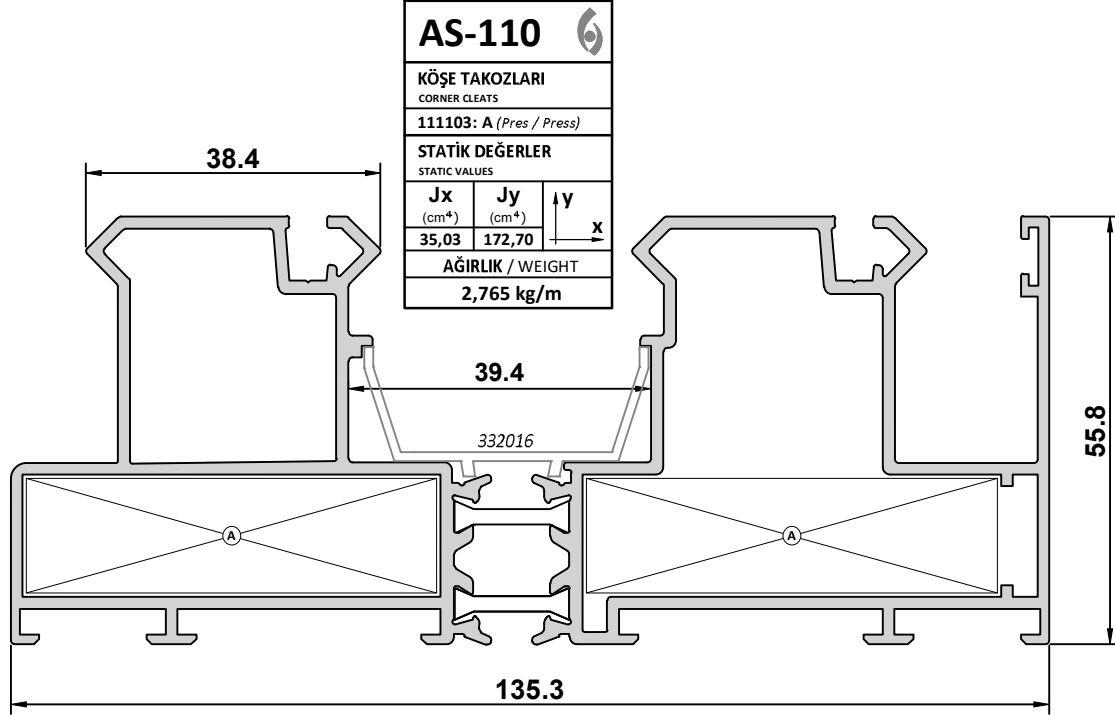
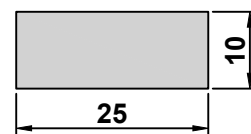
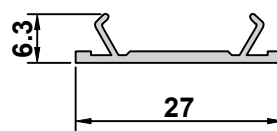
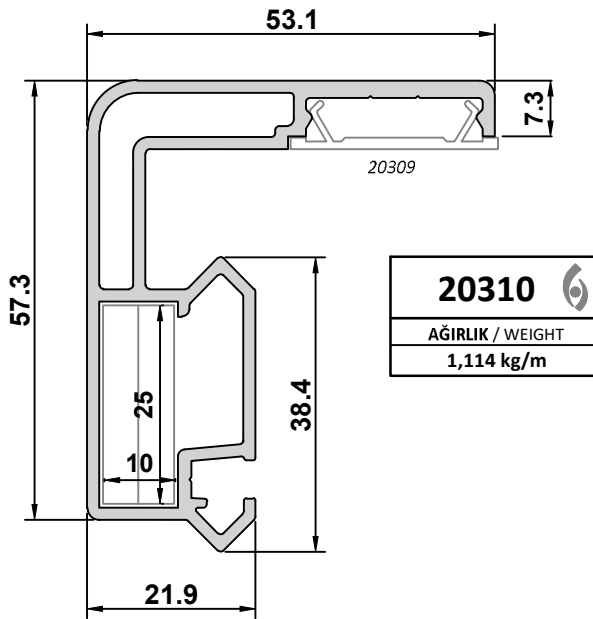
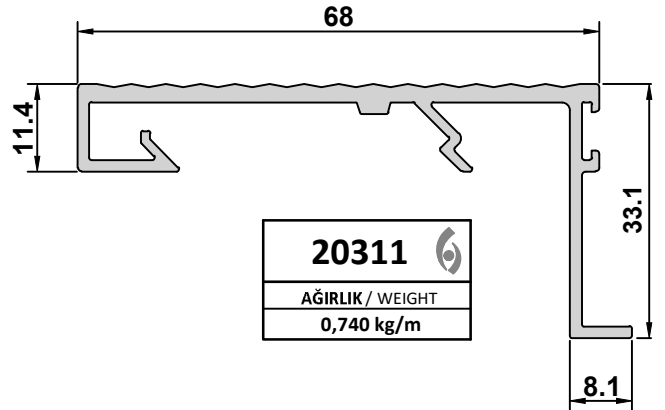
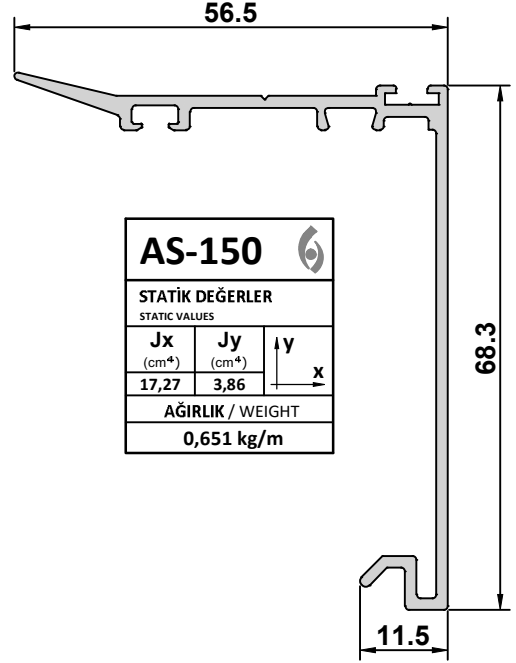
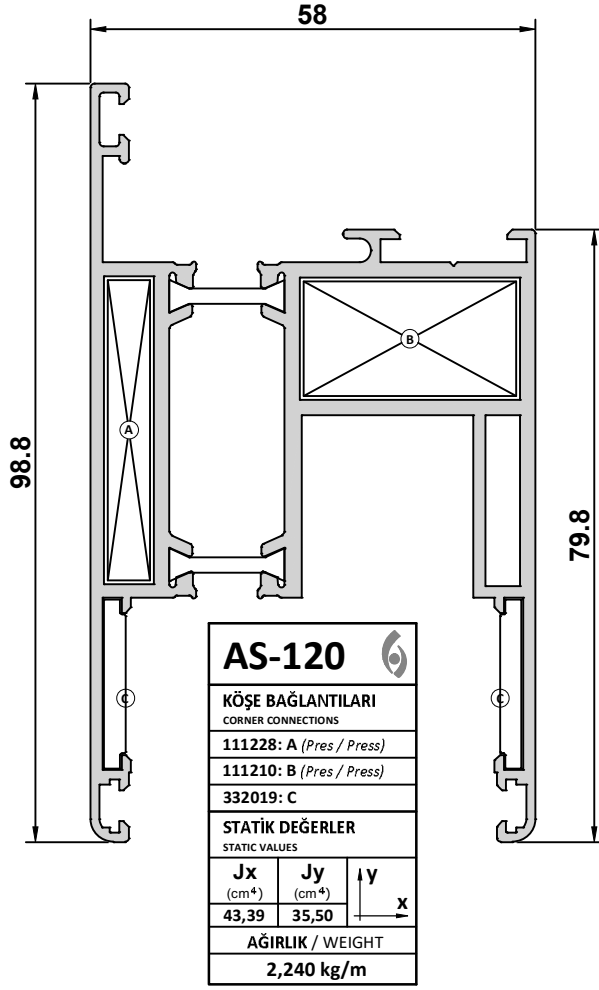

S4000 / SÜRME - SLIDING

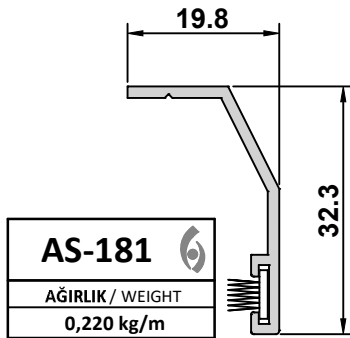
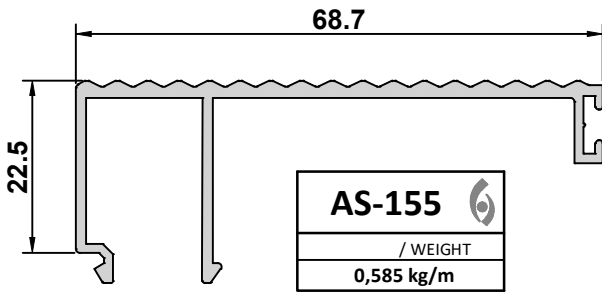

AS-115		
CORNER CLEATS		
111103: A (Pres / Press)		
111024: B (Pres / Press)		
STATİK DEĞERLER		
STATIC VALUES		
Jx (cm ⁴)	Jy (cm ⁴)	y
591,47	51,79	x
AĞIRLIK / WEIGHT		
4,008 kg/m		

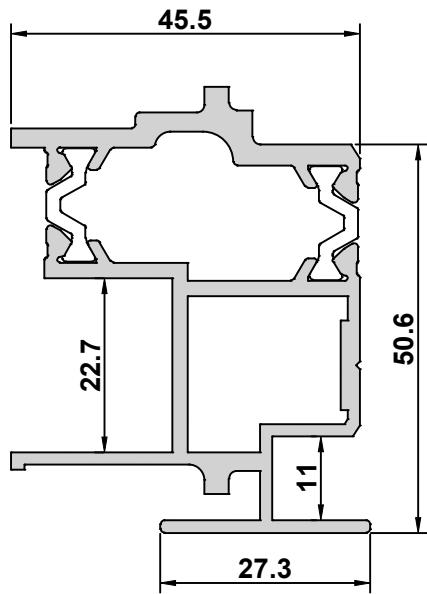

AS-151		
STATİK DEĞERLER		
STATIC VALUES		
Jx (cm ⁴)	Jy (cm ⁴)	y
19,09	10,33	x
AĞIRLIK / WEIGHT		
1,544 kg/m		

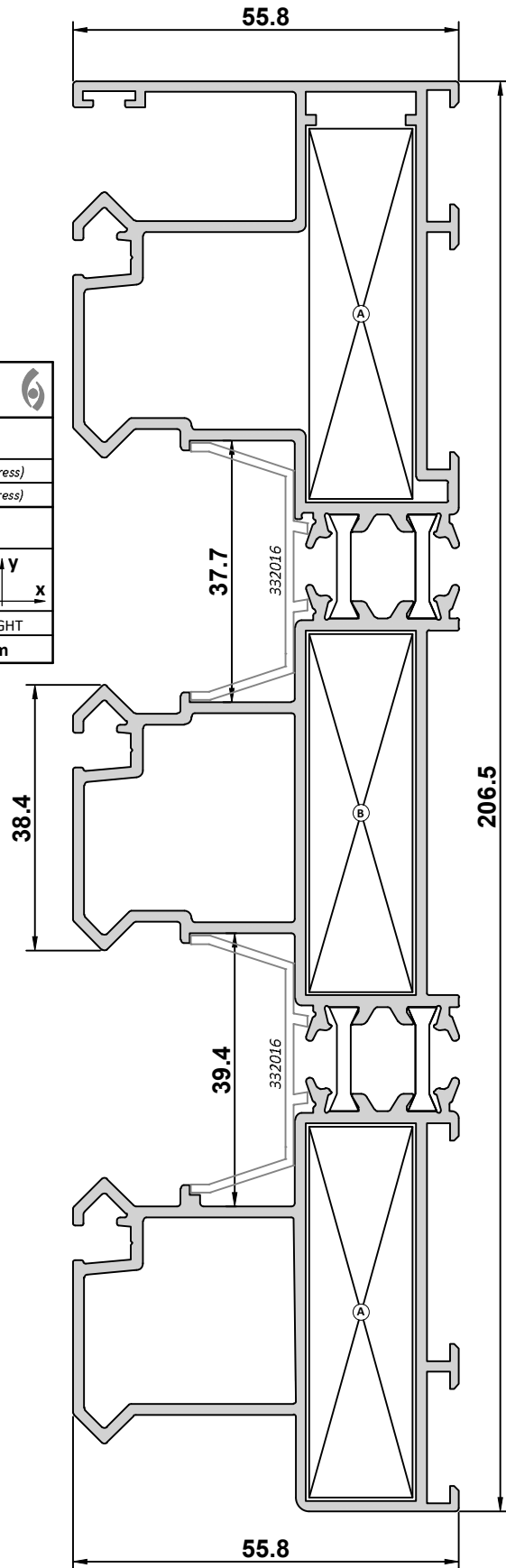

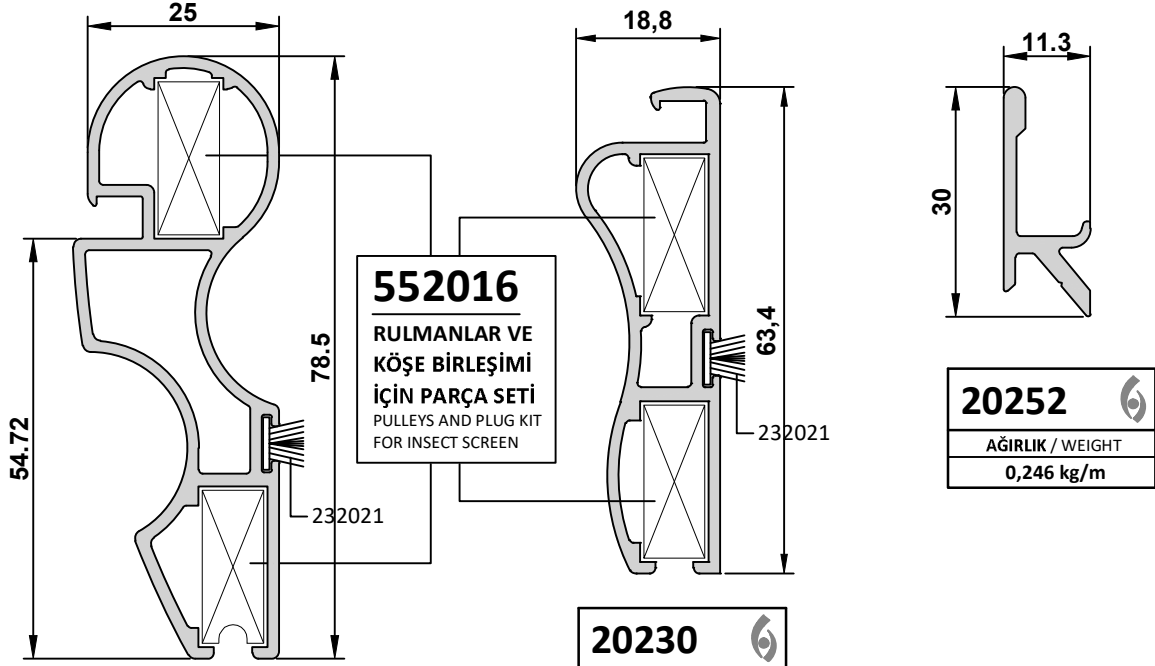

20243		
STATİK DEĞERLER		
STATIC VALUES		
Jx (cm ⁴)	Jy (cm ⁴)	y x
19,02	2,07	
AĞIRLIK / WEIGHT		
0,980 kg/m		

20230		
STATİK DEĞERLER		
STATIC VALUES		
Jx (cm ⁴)	Jy (cm ⁴)	y x
8,91	0,86	
AĞIRLIK / WEIGHT		
0,696 kg/m		

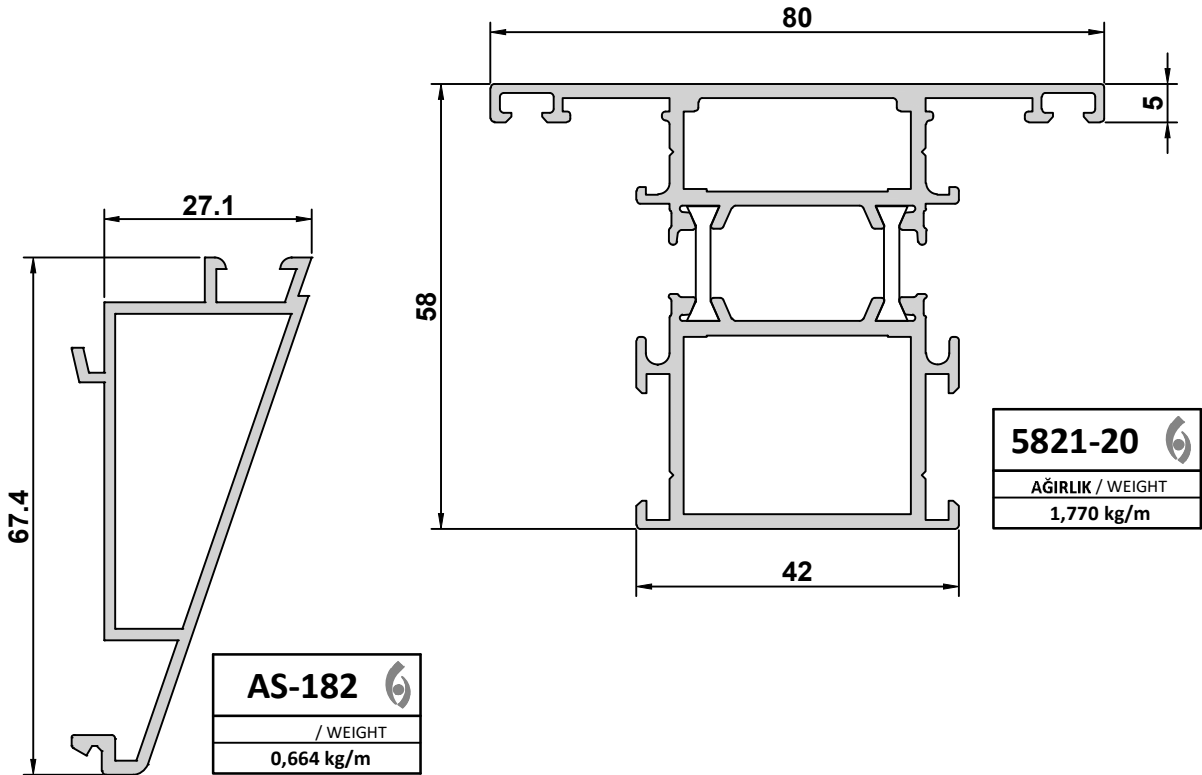

S4000 / SÜRME - SLIDING

ALÜMİNYUM AKSESUAR PROFİLLERİ

PROFILES OF ALUMINIUM ACCESSORIES

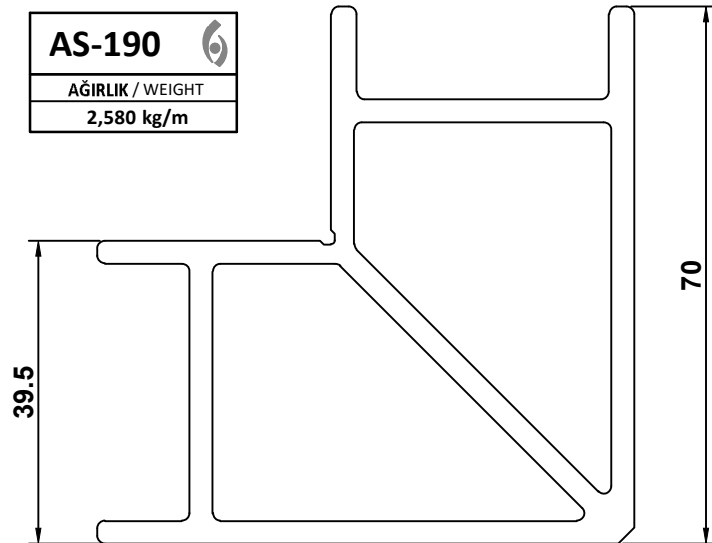
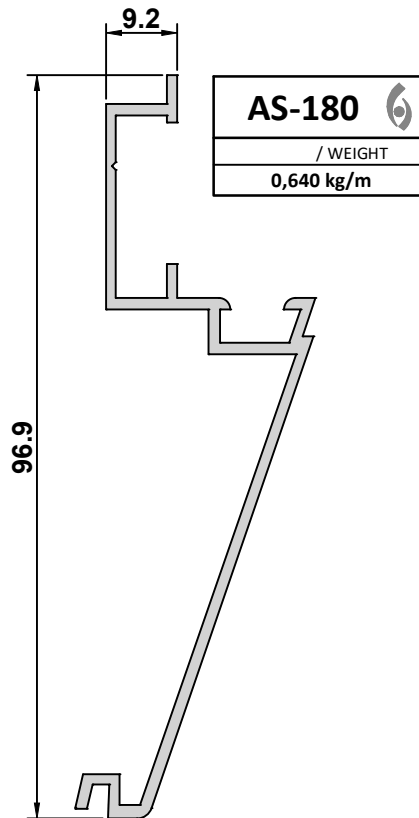
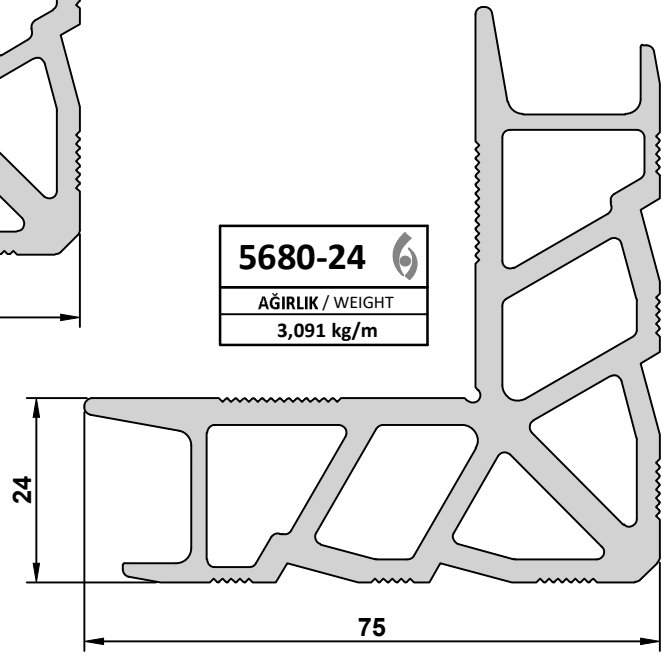
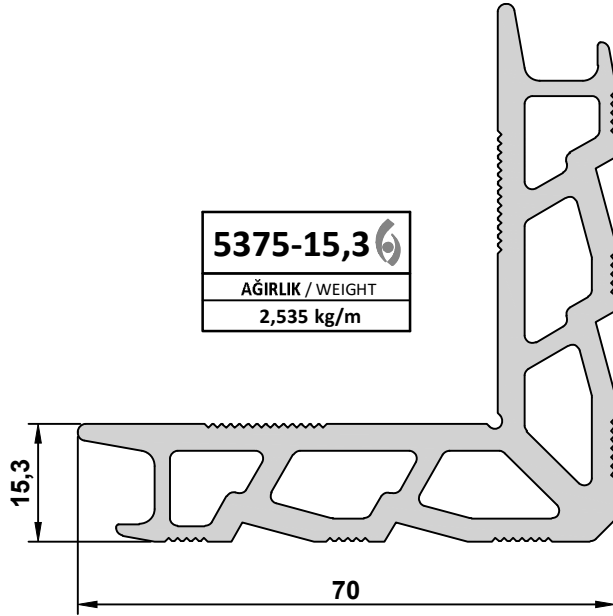

CAM ÇITALARI

GLAZING BEADS

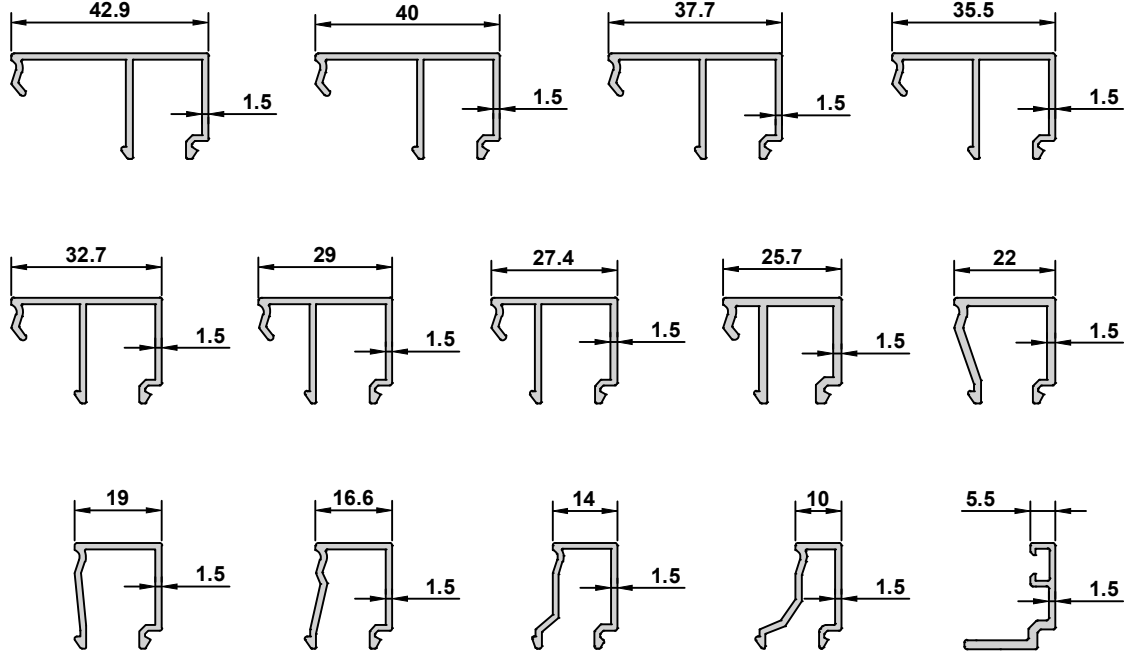

PROFİL NO PROFILE NO	GENİŞLİK WIDHT (mm)	ET KALINLIĞI WALL THICKNESS (mm)	AĞIRLIK WEIGHT (kg)
5647-15	42,9	1,5	0,393
5649-15	40	1,5	0,393
5646-15	37,7	1,5	0,377
7046-14	35,5	1,5	0,344
6500-14	32,7	1,5	0,336
ES4545-13	30,5	1,5	0,306
5645-15	29	1,5	0,344
5644-15	27,4	1,5	0,304
5643-15	25,7	1,5	0,309
5642-15	22	1,5	0,266
Y55410-15	19	1,5	0,247
5641-15	16,6	1,5	0,245
ES4540-13	14	1,5	0,228
5640-15	10	1,5	0,227
5648-15	5,5	1,5	0,220

S4000 / SÜRME - SLIDING

CAM KALINLIĞINA BAĞLI CAM ÇITASI SEÇİM TABLOSU
GLAZING BEAD SELECTION TABLE ACCORDING TO THE GLASS THICKNESS

5647-15	10.1	42.9
5649-15	13	40
5646-15	15.3	37.7
7046-14	17.5	35.5
6500-14	20.3	32.7
ES4545-13	22.5	30.5
5645-15	24	29
5644-15	25.6	27.4
5643-15	27.3	25.7
5642-15	31	22
Y55410-15	34	19
5641-15	36.4	16.6
ES4540-13	39	14
5640-15	43	10
5648-15	47.5	5.5

**** YUKARIDA VERİLEN PROFİL VE FİTİL İLİŞKİLERİ TEORİKTİR.**
THE RELATION BETWEEN PROFILES & GASKETS ARE THEORETICAL AS SEEN ABOVE.

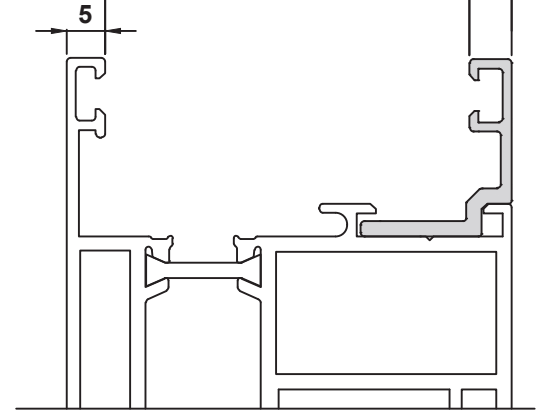
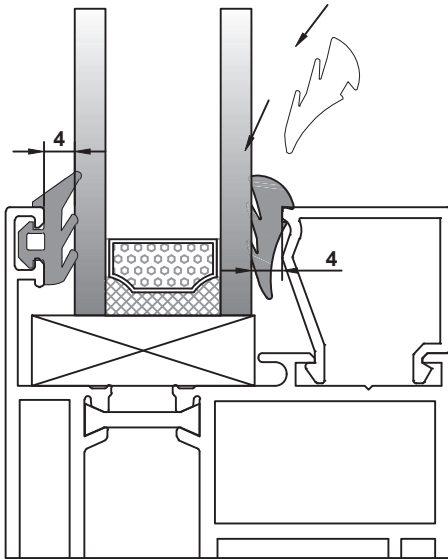

DIŞ FİTİLLER STANDART EBATTA OLUP 4mm KALINLIĞINDADIR. İÇTEKİ KAMA FİTİLİN BOŞLUĞU İSE, MÜMKÜNSE MİNİMUM 3mm OLACAK ŞEKİLDE AYARLANMALIDIR.
THE OUTER GASKET'S DIMENSION ARE STANDARD WITH 4mm THICKNESS. IF IT'S POSSIBLE, THE INNER GASKET'S SPACE ADJUSTED MINIMUM 3mm.

CAM VE PROFİL TOLERANSLARI + VEYA - YÖNDE BERABER ÇALIŞARAK TEORİDE OLMASI GEREKENDEN BÜYÜK VEYA KÜÇÜK BİR FİTİL BOŞLUĞUNA NEDEN OLABİLİR.

THE GLASS AND THE PROFILE TOLERANCES CAN BE WORK AT + OR - DIRECTION TOGETHER. IT CAUSES THE GASKET'S SPACE BIGGER OR SMALLER THAN NORMAL.

İÇ KAMA FİTİLLERİN YERİNE GEÇMESİNDE PROBLEM YAŞANMAMASI İÇİN, ÖNCELİKLE BİR NUMUNE ÜZERİNDE DENENMESİ TAVSİYE EDERİZ.

WE ADVICE THAT THE INNER GASKET AND GLAZING BEAD RELATION SHOULD BE CHECKED ON A MOCK-UP BEFORE.